

Information is provided to:

Quote Up-Date a Quote Q _____

Order Quote # Q _____

Purchase Order # _____

Ordered By: _____

Client's Name (Last, First): _____, _____ Date: ___ / ___ / ___ Dealer: _____

Sales Person (RTS): _____ Phone: _____ Fax: _____ E-Mail: _____

Inside Contact: _____ Phone: _____ Fax: _____ E-Mail: _____

Mobility Brand: _____ Model: _____ Size: ___ (W) x ___ (D)

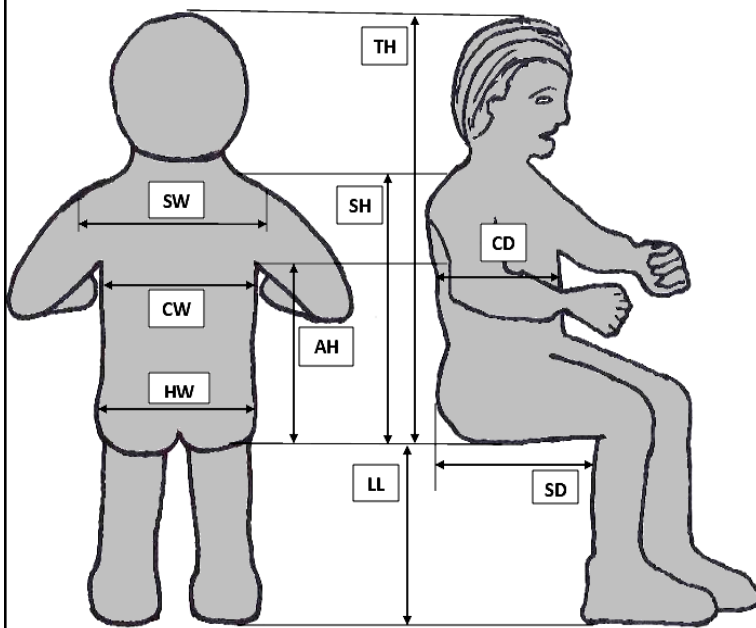

- Interim Fit One Piece System
- Full Width Mount
- Between Rails Mount
- Seat to Back Angle _____

Dimension		Letter	Description
		TH	Seat to Top Of Head
Rt	Lf	SH	Seat to Top of Shoulder
Rt	Lf	AH	Seat to Axilla
Rt	Lf	SD	Seat Depth
Rt	Lf	LL	Lower Leg Length
		CD	Chest Depth
		SW	Shoulder Width
		CW	Chest Width
		HW	Hip Width

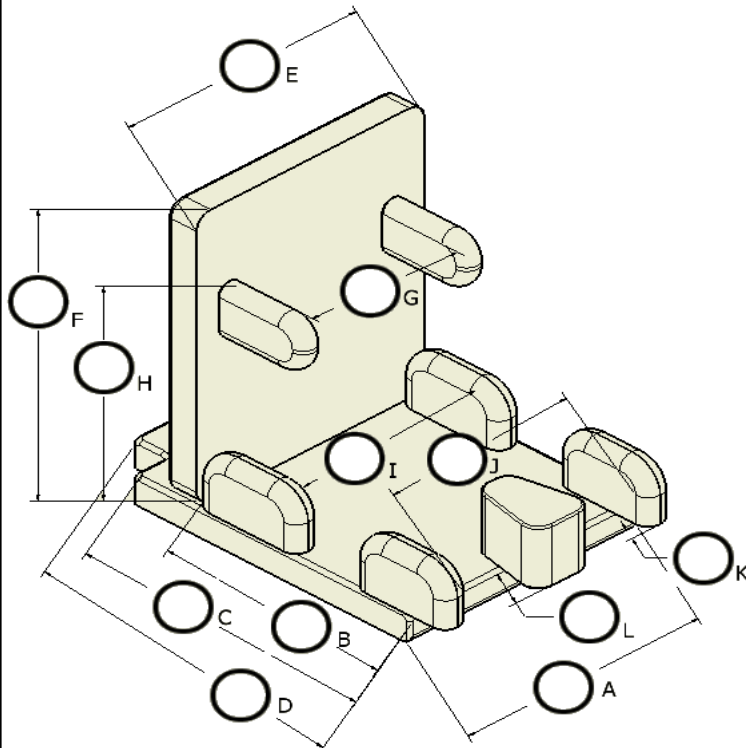

Dimension		Letter	Description
		A	Seat Width
Rt	Lf	B	Seat Depth, Actual
Rt	Lf	C	Seat Depth, Before Tail
Rt	Lf	D	Seat Depth, Overall
		E	Back Width
		F	Back Height
		G	Lateral Trunk Width
		H	Lateral Trunk Height
		I	Lateral Hip/Thigh Width
		J	Lateral Knee Width
		K	Lateral Knee Off Seat
		L	Medial Knee Off Seat

Bio ST[®] Bio ST-HD[®]

FITTING / ORDER FORM

Information is provided to:

Quote Up-Date a Quote Q _____

Order Quote # Q _____

Purchase Order # _____

Ordered By: _____

Bio ST Seat Inserts

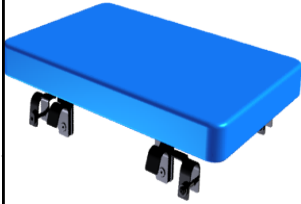

Includes 2" Med Pkg of Foam, Zippered Blk Neoprene Cover, Std steel angle adjustable hardware

SS01

Bio ST Seat Cushions

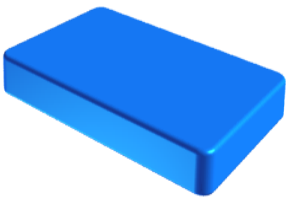

Includes 2" Med Package of Foam, Zippered Blk Neoprene Cover, 1/4" HDPE plate

SSC1P

Bio HD Seat Inserts



Includes 1/2" HDPE Plate with 2" Med Pkg of Foam, Zippered Blk Neoprene Cover, Std steel angle adjustable hardware

HS01

Bio ST Seat Interfaces to Accept Cushions



Includes 1/2" HDPE secured by flush steel mounting hardware

S90



Includes 1/2" HDPE secured by Std steel angle adjustable hardware

S91

Modifications to the Shape of a Solid Seat Insert or Cushion A 3.1.3.

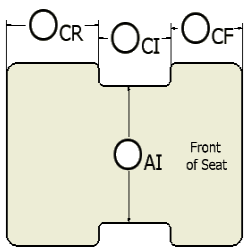

'I' Modification

SSI

CR: _____ CI: _____
CF: _____ AI: _____

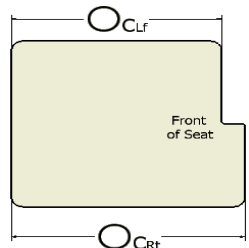

90 Degree Leg Length Discrepancy

SSR

CLF: _____
CRF: _____

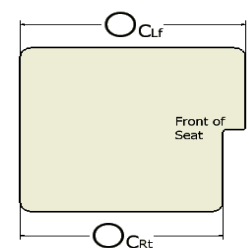

90 Degree Leg Length Discrepancy

SSL

CLF: _____
CRF: _____

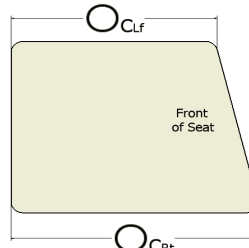

Angled Cut Leg Length Discrepancy

SSE

CLF: _____
CRF: _____

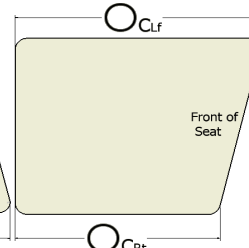

Angled Cut Leg Length Discrepancy

SSD

CLF: _____
CRF: _____

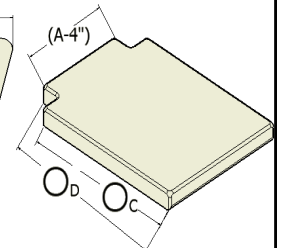

Notch for Back Canes

SSB

C: _____
D: _____

Modifications to the Contour of a Solid Seat Insert or Cushion A 3.1.4.

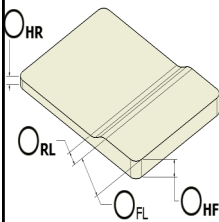

Anti Thrust Construction

SCA

HR: _____ HF: _____
FL: _____ RL: _____

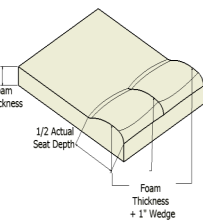

Abductor and Adductor Contour

SCG

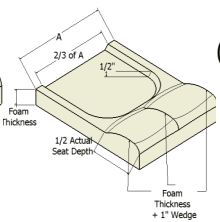

BioWell: Abductor & Adductor Contour w/ Ischial Recess

SCE

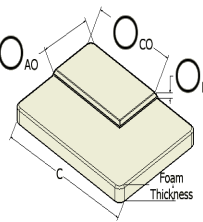

Left Pelvic Obliquity Buildup

SCO

AO: _____ CO: _____
HO: _____

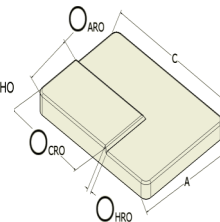

Right Pelvic Obliquity Buildup

SCP

ARO: _____ CRO: _____
HRO: _____

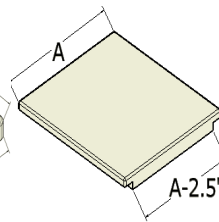

Seat Rail Cutout

SCR

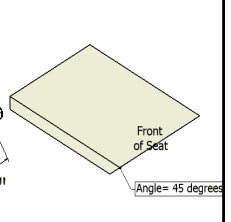

Undercut Front of Seat

SCU

Foam Options Seat

- SRS** Soft Package: 1/2" Soft Sunmate on 1/2" Confor on 1" Soft Sumate
- SRM** Medium Package: 1" Soft Sunmate on 1" Medium Sunmate
- SRF** Firm Package: 1/2" Soft Sunmate on 1.5" Medium Sunmate

- SFA** Build your own. Any 2" Combination of 1/2" of Sunmate - Confor - Volara Foams
Top: _____ 2nd: _____
3rd: _____ 4th: _____
- SFX** Custom: _____
- SFW** Siliconize Foam

Information is provided to:
 Quote Up-Date a Quote Q _____
 Order Quote # Q _____
 Purchase Order # _____
 Ordered By: _____

Cover Options Seat

- SCV Removable
- SCY ___ Extra Covers

- N__ Neoprene Color _____
- V__ Vinyl Color _____ US-__
- BN Ballistic Nylon, Black
- KN Spacer Mesh, Black

- DA Darlex, Black
- CD Dartex, Black
- RD Reverse Dartex, Black
- PF Polarflece

Hardware Options Seat

- MSS (4) J & L w/Horseshoe Clamp
- QRA (4) J & L w/up to (4)Versalock
- QRB (2) J & L w/Horseshoe Clamp + (2)Quick Clamp
- MAB Modify to BioSelect Hinged Seat-Back

- MSU BioSnap
- QRG BioSnap w/Grenade Pin
- QRD Knobs (2) w/ J & L(2)
- MSV Flush mount
- MSW Flush mount w/Grenade Pin

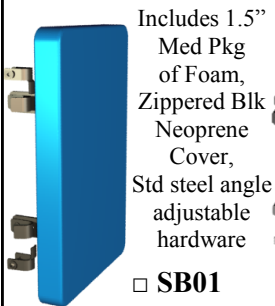
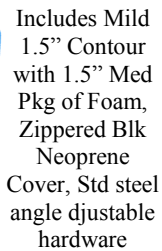
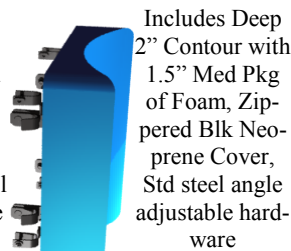
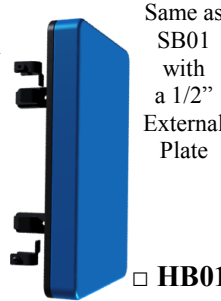
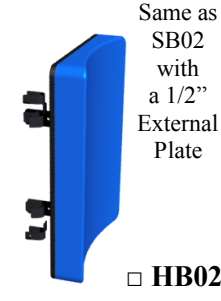
Bio ST Back Inserts

 SB01

 SB02

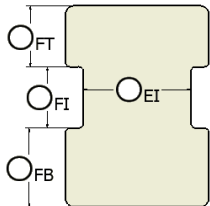
 SB03
Bio ST-HD Back Inserts

 HB01

 HB02

 HB03
Modifications to the Shape of a Solid Back Insert

A 3.2.3.



'I' Modification

 BSI

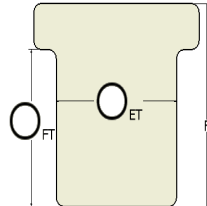
 FT: _____ FB: _____
 FI: _____ EI: _____

'T' Modification

 BST

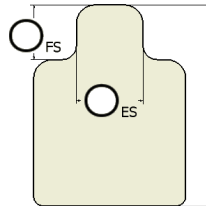
 FT: _____
 ET: _____

Scapular Cutouts

 BSS

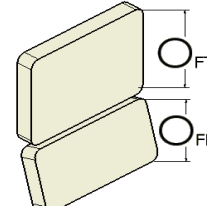
 FS: _____
 ES: _____

Bi-Angular Back

 BSH

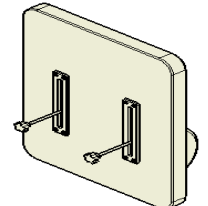
 FT: _____
 FB: _____

Ht, Depth & Angle Adj. Lumbar Support

 BSL
Modifications to the Contour of a Solid Back Insert

A 3.2.4.

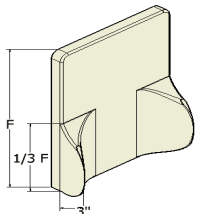

Mild Contour Back, 1/3 Ht of Back

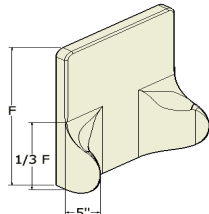
 BCQ

Deep Contour Back, 1/3 Ht of Back

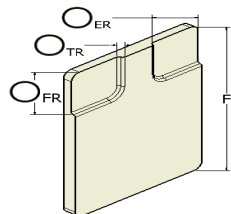
 BCR

Reduce Foam for Scapular Relief

 BCS

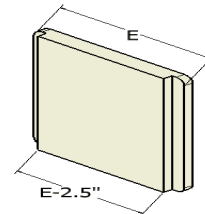
 ER: _____ FR: _____
 TR: _____

Cutouts for Back Canes

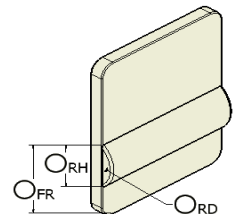
 BCC

Internal Lumbar Roll

 BCL

 RD: _____ RH: _____
 FR: _____

Information is provided to:

-
- Quote
-
- Up-Date a Quote Q _____
-
-
- Order Quote # Q _____
-
- Purchase Order # _____
-
- Ordered By: _____

Foam Options Back

-
- BRS**
- Soft Package: 1/2" Soft Sunmate on 1/2" Confor on 1/2" Soft Sumate
-
-
- BRM**
- Medium Package: 1" Soft Sunmate on 1/2" Medium Sunmate
-
-
- BRF**
- Firm Package: 1/2" Soft Sunmate on 1" Medium Sunmate

-
- BFA**
- Build your own. Any 1.5" Combination of 1/2" of Sunmate - Confor - Volara Foams
-
- Top: _____ 2nd: _____
-
- 3rd: _____
-
-
- BFX**
- Custom: _____
-
- _____
-
-
- BFW**
- Siliconize Foam

Cover Options Back

-
- BCV Removable
-
-
- BCY ___ Extra Covers
-
-
- N__ Neoprene Color _____
-
-
- V__ Vinyl Color _____ US-_____
-
-
- BN Ballistic Nylon, Black
-
-
- KN Spacer Mesh, Black
-
-
- DA Darlex, Black
-
-
- CD Dartex, Black
-
-
- RD Reverse Dartex, Black
-
-
- PF Polarflece

Hardware Options Back

-
- MSS (4) J & L w/Horseshoe Clamp
-
-
- QRA (4) J & L w/up to (4)Versalock
-
-
- QRB (2) J & L w/Horseshoe Clamp + (2)Quick Clamp
-
-
- MAB Modify to BioSelect Hinged Seat-Back (n/c)
-
-
- MSU BioSnap
-
-
- QRG BioSnap w/Grenade Pin
-
-
- QRD Knobs (2) w/ J & L(2)
-
-
- MSV Flush mount
-
-
- MSW Flush mount w/Grenade Pin

Positioning Support Pads B 1
Lateral Trunk Pads B 1.1.1

-
- BLD**
- Flat, X-Small 3 H x 4 D
-
-
- BLS**
- Flat, Small 4 H x 4 D
-
-
- BLM**
- Flat, Medium 4 H x 5 D
-
-
- BLL**
- Flat, Large 4 H x 6 D
-
-
- BLO**
- Flat, X-Large 5 H x 6 D
-
-
- BLX**
- Flat, Custom Specs
-
-
-
- BND**
- Contoured, X-Small 3 H x 4 D
-
-
- BNS**
- Contoured, Small 4 H x 4 D
-
-
- BNM**
- Contoured, Medium 4 H x 5 D
-
-
- BNL**
- Contoured, Large 4 H x 6 D
-
-
- BNO**
- Contoured, X-Large 5 H x 7 D
-
-
- BNX**
- Contoured, Custom Specs

Lateral Hip/Thigh Pads B 1.1.2

-
- BHD**
- Flat fr. Back, X-Small 4 H x 6 D
-
-
- BHS**
- Flat fr. Back, Small 4 H x 9 D
-
-
- BHM**
- Flat fr. Back, Medium 4 H x 12 D
-
-
- BHL**
- Flat fr. Back, Large 4 H x 14 D
-
-
- BHO**
- Flat fr. Back, X-Large 4 H x 16 D
-
-
- BHX**
- Flat fr. Back, Custom Specs
-
-
-
- BID**
- Contoured fr. Back, X-Small 4 H x 6 D
-
-
- BIS**
- Contoured fr. Back, Small 4 H x 9 D
-
-
- BIM**
- Contoured fr. Back, Medium 4 H x 12 D
-
-
- BIL**
- Contoured fr. Back, Large 4 H x 14 D
-
-
- BIO**
- Contoured fr. Back, X-Large 4 H x 16 D
-
-
- BIX**
- Contoured fr. Back, Custom Specs

Lateral Knee Pads B 1.1.3

-
- SLD**
- Flat, X-Small 3 H x 4 D
-
-
- SLS**
- Flat, Small 4 H x 4 D
-
-
- SLM**
- Flat, Medium 4 H x 5 D
-
-
- SLL**
- Flat, Large 4 H x 6 D
-
-
- SLO**
- Flat, X-Large 5 H x 6 D
-
-
- SLX**
- Flat, Custom Specs
-
-
-
- SND**
- L-Shaped, X-Small 3 H x 4 D
-
-
- SNS**
- L-Shaped, Small 4 H x 4 D
-
-
- SNM**
- L-Shaped, Medium 4 H x 5 D
-
-
- SNL**
- L-Shaped, Large 4 H x 6 D
-
-
- SNO**
- L-Shaped, X-Large 5 H x 7 D
-
-
- SNX**
- L-Shaped, Custom Specs

-
- SHD**
- Flat fr. Seat, X-Small 4 H x 6 D
-
-
- SHS**
- Flat fr. Seat, Small 4 H x 9 D
-
-
- SHM**
- Flat fr. Seat, Medium 4 H x 12 D
-
-
- SHL**
- Flat fr. Seat, Large 4 H x 14 D
-
-
- SHO**
- Flat fr. Seat, X-Large 4 H x 16 D
-
-
- SHJ**
- Flat fr. Seat, XX-Large 5 H x 16 D
-
-
- SHX**
- Flat fr. Seat, Custom Specs
-
-
-
- SID**
- Contoured fr. Seat, X-Small 4 H x 6 D
-
-
- SIS**
- Contoured fr. Seat, Small 4 H x 9 D
-
-
- SIM**
- Contoured fr. Seat, Medium 4 H x 12 D
-
-
- SIL**
- Contoured fr. Seat, Large 4 H x 14 D
-
-
- SIO**
- Contoured fr. Seat, X-Large 4 H x 16 D
-
-
- SIJ**
- Contoured fr. Seat, XX-Large 5 H x 16 D
-
-
- SIX**
- Contoured fr. Seat, Custom Specs

Client's Name: _____, _____
Date: ___/___/___ Dealer: _____
Sales Person (RTS): _____

FITTING / ORDER FORM

Lateral Pads Mounting Hardware (Pre-Config) B 1.2.2				Lats	Hips	L-Knee	
<input type="checkbox"/>	<input type="checkbox"/>	<input type="checkbox"/>	LBB Straight Bracket (90 deg. spring steel)	<input type="checkbox"/>	<input type="checkbox"/>	<input type="checkbox"/>	LOB Offset Bracket (Adj. .75" to 3")
<input type="checkbox"/>	<input type="checkbox"/>	<input type="checkbox"/>	LBK Straight Bracket w/Single Knob	<input type="checkbox"/>	<input type="checkbox"/>	<input type="checkbox"/>	LOK Offset Bracket w/Single Knob
<input type="checkbox"/>	<input type="checkbox"/>	<input type="checkbox"/>	LSB Swing Away Bracket	<input type="checkbox"/>	<input type="checkbox"/>	<input type="checkbox"/>	LOS Offset Swing Away Bracket
<input type="checkbox"/>	<input type="checkbox"/>	<input type="checkbox"/>	LSW Swing Away w/Winter-Summer	<input type="checkbox"/>	<input type="checkbox"/>	<input type="checkbox"/>	LOR Offset Swing Away w/Wint-Summer
<input type="checkbox"/>	<input type="checkbox"/>	<input type="checkbox"/>	LSK Swing Away w/Single Knob	<input type="checkbox"/>	<input type="checkbox"/>	<input type="checkbox"/>	LOT Offset Swing Away w/Single Knob
<input type="checkbox"/>	<input type="checkbox"/>	<input type="checkbox"/>	LOF Removable Bracket (90 deg.)	<input type="checkbox"/>	<input type="checkbox"/>	<input type="checkbox"/>	LOW Offset Winter-Summer
				<input type="checkbox"/>	<input type="checkbox"/>	<input type="checkbox"/>	LOX Custom Mounting Hardware

Medial Knee Pads B 1.1.4					
<input type="checkbox"/>	SMD Wedge, X-Small	WR:1.5; WF:3; D:4; H:3	<input type="checkbox"/>	SQD Oval, X-Small	W:2; D:4; H:3
<input type="checkbox"/>	SMS Wedge, Small	WR:2; WF:4; D:4; H:3	<input type="checkbox"/>	SQS Oval, Small	W:3; D:4; H:3
<input type="checkbox"/>	SMM Wedge, Medium	WR:2; WF:4; D:5; H:4	<input type="checkbox"/>	SQM Oval, Medium	W:3; D:5; H:4
<input type="checkbox"/>	SML Wedge, Large	WR:3; WF:5; D:6; H:4	<input type="checkbox"/>	SQL Oval, Large	W:4; D:6; H:4
<input type="checkbox"/>	SMO Wedge, X-Large	WR:4; WF:6; D:6; H:4	<input type="checkbox"/>	SQX Oval, Custom	Specs
<input type="checkbox"/>	SMX Wedge, Custom	Specs			
<input type="checkbox"/>	SPD L-Wedge, X-Small	WR:1.5; WF:3; D:4; H:3; HF:5	<input type="checkbox"/>	SUD L-Oval, X-Small	W:2; D:4; HR:3; HF:5
<input type="checkbox"/>	SPS L-Wedge, Small	WR:2; WF:4; D:4; H:3; HF:5	<input type="checkbox"/>	SUS L-Oval, Small	W:3; D:4; HR:3; HF:5
<input type="checkbox"/>	SPM L-Wedge, Medium	WR:2; WF:4; D:5; H:4; HF:6	<input type="checkbox"/>	SUM L-Oval, Medium	W:3; D:5; HR:4; HF:6
<input type="checkbox"/>	SPL L-Wedge, Large	WR:3; WF:5; D:6; H:4; HF:6	<input type="checkbox"/>	SUL L-Oval, Large	W:4; D:6; HR:4; HF:6
<input type="checkbox"/>	SPO L-Wedge, X-Large	WR:4; WF:6; D:6; H:4; HF:6	<input type="checkbox"/>	SUX L-Oval, Custom	Specs
<input type="checkbox"/>	SPX L-Wedge, Custom	Specs			

Medial Knee Mounting Hardware (Pre-Config) B 1.2.2.4	
<input type="checkbox"/>	AWF FlipDown Hardware for Medial Knee
<input type="checkbox"/>	AWR Removable Hardware for Medial Knee
<input type="checkbox"/>	AWB FlipDown & Rem. Hardware for medial Knee

Miscellaneous:

BioForm Std. Anterior Trunk Support

- NR** Neoprene, **T** (XXS); **D** (XS); **S** (S); **M** (M); **L** (L); **O** (XL)
 NS Neo-Snap, **T** (XXS); **D** (XS); **S** (S); **M** (M); **L** (L); **O** (XL)
 NH Neo-'H', **S** (S); **M** (M); **L** (L)
 NM Neo-6Point, **T** (XXS); **D** (XS); **S** (S); **M** (M); **L** (L); **O** (XL)
 DR Rev.Dartex, **T** (XXS); **D** (XS); **S** (S); **M** (M); **L** (L); **O** (XL)
 DH Rev.Dartex-'H', **S** (S); **M** (M); **L** (L)
 VR ___ Vinyl, **T** (XXS); **D** (XS); **S** (S); **M** (M); **L** (L); **O** (XL)
 VS ___ Vinyl-Snap, **T** (XXS); **D** (XS); **S** (S); **M** (M); **L** (L); **O** (XL)
 VH ___ Vinyl-'H', **S** (S); **M** (M); **L** (L)
 VM ___ Vinyl-6Pt., **T** (XXS); **D** (XS); **S** (S); **M** (M); **L** (L); **O** (XL)
 VN Ballistic Nylon, **T** (XXS); **D** (XS); **S** (S); **M** (M); **L** (L); **O** (XL)

BioForm Low-Profile Anterior Trunk Support

- NL** Neoprene, **D** (XS); **S** (S); **M** (M); **L** (L)
 DL Rev. Dartex, **D** (XS); **S** (S); **M** (M); **L** (L)
 VL ___ Vinyl, **D** (XS); **S** (S); **M** (M); **L** (L)

Headrest

- HWMIC** BioCurve Medium Pad w/removable Height, Depth & angle adj. Hardware
 HWLIC BioCurve Large Pad w/removable Height, Depth & angle adj. Hardware

Ankle or Toe Straps

- MDS** BioForm, D-ring Velcro 1"Strap, S
 MDM BioForm, D-ring Velcro 1"Strap, M
 MDL BioForm, D-ring Velcro 1"Strap, L
 MFS BioForm, Fastex Buckle 1"Strap, S
 MFM BioForm, Fastex Buckle 1"Strap, M
 MFL BioForm, Fastex Buckle 1"Strap, L

Scuba Heel Loops

- LCS** BioForm Scuba Heel Loops, S
 LCM BioForm Scuba Heel Loops, M
 LCL BioForm Scuba Heel Loops, L

NOTES: _____
